

			2.Remove the dirt on the magnetic card by soft paper, if the card has problem, try to change the card in the issuer bank. 3.Pay attention on the surface of the magnetic direction and the speed swiping card should keep equality.
Others	External pinpad is not available	The connect cable of external pinpad is not connect properly, the terminal model is without external pinpod.	Confirm the pinpad cable is connect with the dock PIN port properly; Or check the model selection in system setting.
	Communication is good, but no transaction	RAM is full.	Please do the settlement firstly.

### Package List

No.	Item	Quantity
1	T2 EFT-POS TERMINAL	1
1	T2 OPERATION MANUAL	1
1	TELEPHONE LINE	1
1	POWER ADAPTOR	1

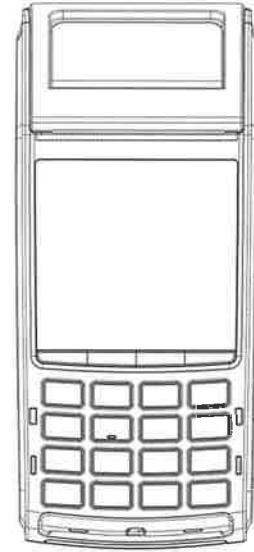

### Clarify

Shenzhen Xinguodu Technology Co.,LTD retain the right to modify the operating manual without inform in advance and keep improve the veracity, sufficiency and integrity of information.

Shenzhen Xinguodu Technology Co.,LTD will not take legal responsibility for the adverse effect of using this product without following the manual and use spare parts which is not from our company.

The Copyright of this manual is belong to Shenzhen Xinguodu Technology Co.,LTD

## T2 Operation Manual

Finance POS terminal

Components	Hazardous and noxious substances or elements					
	Pb	Hg	Cd	Cr(VI)	PBB	PBDE
PCB Components	X	○	○	○	○	○

**Notes:** 1) ○ means the content of this hazardous and noxious substance in all the homogeneous material of the component is below the requirement of SJ/T 11363-2006 standard.  
2) X means the content of this hazardous and noxious substance at least in certain homogeneous material is higher than the requirements of SJ/T 11363-2006 standard; but the components marked by "X" in the above form are all due to the current industry technology develop level and cannot realize the substitution of the hazardous and noxious substances or elements.

#### Environmental protection indication:

for the products which arrives or exceeds the use life, should be recycled used according to <The Management of Electronic and Information Product >, cannot discard arbitrarily.

SHENZHEN XINGUODU TECHNOLOGY CO.,LTD

Company address: 17B JinSong Mansion, Terra Industrial & Trade Park  
Chegongmiao, Futian District, Shenzhen

Manufacturer: Shenzhen Xinguodu Technology Co., Ltd

Factory address: C Building Dagang Industry Area, Changzhen District,  
Gongming, Guangming, Shenzhen

Telephone: 400-609-6969

www.nexgo.cn

## Attention Of Installation And Operation



- Please follow the instruction strictly when install and connect the terminal.
- The terminal can just use specified power adaptor, cannot replace by other, or will cause the terminal work improperly, even damage the terminal.
- Do not damage the power cable and power adaptor. It can't be used any more if the power cable or power adaptor is damaged.
- Please check power supply socket whether complying with terminal set voltage before insert the AC socket. Recommend to choose the fuse socket, and grounding well.
- Please leave the terminal away from liquid, and forbidden splash into any liquid or electric conduction material, otherwise it will cause a short-circuit or damage the terminal.
- Please do not insert any foreign material into any ports, it will damage the terminal seriously.
- Please contact the professional POS maintainer when the terminal have fault, users or other non-qualified POS maintainer should not repair the terminal.
- Please use the standard print paper in case of paper jam or printer damage.
- Please do not shake or knock the terminal.
- Please do not use or place flammability spray, painting etc., in case of fire.
- Forbid to disassemble or remake the terminal, Forbidden to use the terminal in illegal way, offenders will stand legal responsibility.

## Common Fault Process

If the above solution can't solve the problem or have other questions, please contact maintenance person.

Category	Fault	Reason	Solution
Power on/off	No display when power on	1. Out of battery. 2. AC power supply do not plug well.	1. Connect AC power. 2. Check if the AC power plug well or not.
Communi-cation	First installation, cannot dial up, always display Dialing, Please Wait	Without setting outside line number, or need delay after dial the outside line.	Add one to 4 commas at the front of outside line, one comma stands for waiting one second, Dial again one second after detect dial tone. If add 5 comma, then no need detect the dial tone, wait and continue dial after off hook.
	Display Telephone Line is not insert properly or telephone line being used	The telephone line is not insert properly, or the telephone number setting incorrect.	The telephone line is not insert properly, or the telephone number setting incorrect.
Printer	No display	The paper is upside down in the thermal printer.	Reset the print paper as the instruction.
	Print color is too light	Printer paper is not good quality.	Change good quality paper.
Card Read failure	Prompt Card Read Error. Please Swipe the Card Again	1. There is dirt on the magnetic card. 2. Magnetic card is dirty or demagnetization. 3. Swipe the card in a wrong way.	1. A piece of moderate hard cardboard put card slot, and drag several times by light horizontal and vertical direction, and then wipe away the dirt from the head.

### Install PSAM/SIM/SD card :

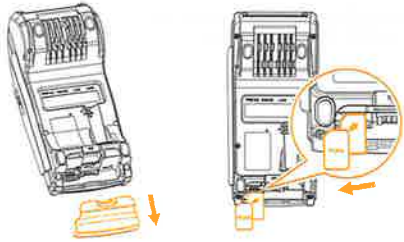

- 1 Open back cover.
- 2 Put the PSAM/SIM/SD card into the card slot following the picture(notice please make sure the chip side is toward terminal, every card slot is double layer can insert two cards.

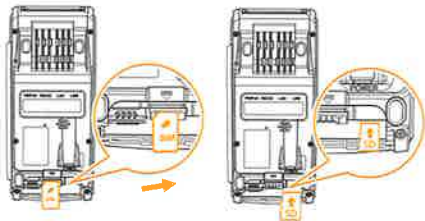

- 1 Install or dismount PSAM/SIM/SD card, please make sure the terminal is power off, or may damage the card.
- 2 PSAM/SIM/SD card cannot stick with adhesive sticker or label which will influence the thickness of card, to avoid it cannot put into slot.

### Dismount back cover

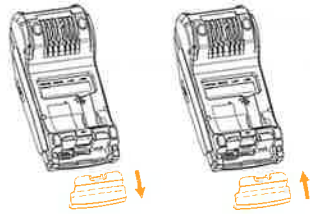

- 1 Aim the back cover at slot.
- 2 Clench and press back cover until you heard the Click, then the back cover is installed. Clench and lift the cover with the edge to dismount the back cover.

### Install the print paper

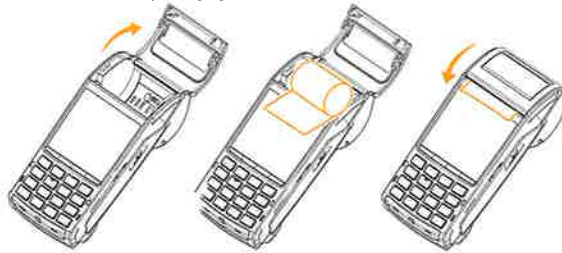

- 1 Lift the paper cover ,open it.
- 2 Strip off the paper and drag one side of the paper, put it into the paper cabin follow the direction in picture. Leave little paper upside of the paper cutter.
- 3 Buckle up the paper cover, heard click means it is straining.

Notice:Please notice the direction of paper when install the thermal paper, face down the open side as the picture shows, or cannot print the character.

### Tear-off Print Paper

Hold the extend print paper, tear-off the paper along with the direction shows in the picture, from left to right, the strength should keep fast and equality.



## Structure Description

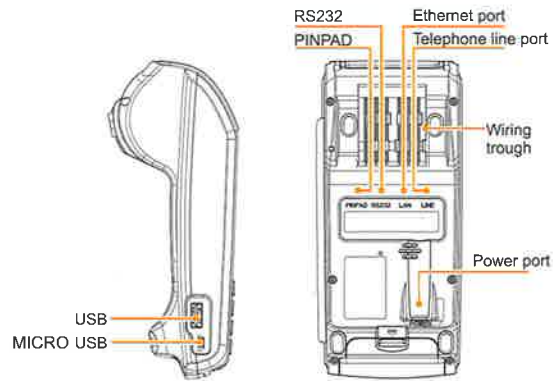
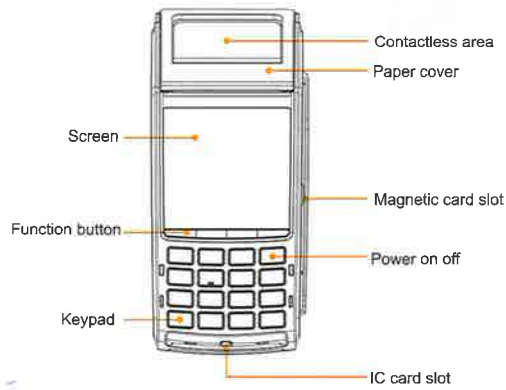

## Instructions

### Power on /off

**Power on :** Press the red key button " ⏻ " for 3-4 seconds, the backlight lighting, POS power on.  
**Power off:** Press the red key button " ⏻ ", the screen will show POWER OFF, CONFIRM or CANCEL, press Confirm then terminal power off.

### Magnetic card

Please put the card magnetic strip towards to track device inside when swipe the card, it can support both directions; must confirm speed of swiping card is stable and constant.

Notice: if the track of magnetic card is damaged or the swipe way is incorrect, may cause transaction failure.



### Contact IC Card

The IC card slot is in the bottom of terminal, insert the card horizontally when insert card, and guarantee IC card chip side is upside; the IC card should be in the IC card slot during the whole transaction, showing as follows.

Notice: Some IC card chip is damaged or oxidation, may cause transaction failure.

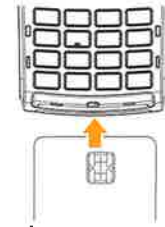

### Contactless IC card

Please tap the card on the top of printer cover as following picture and hold for 1 second until you hear a prompt tone, which shows that the transaction is approved.

