

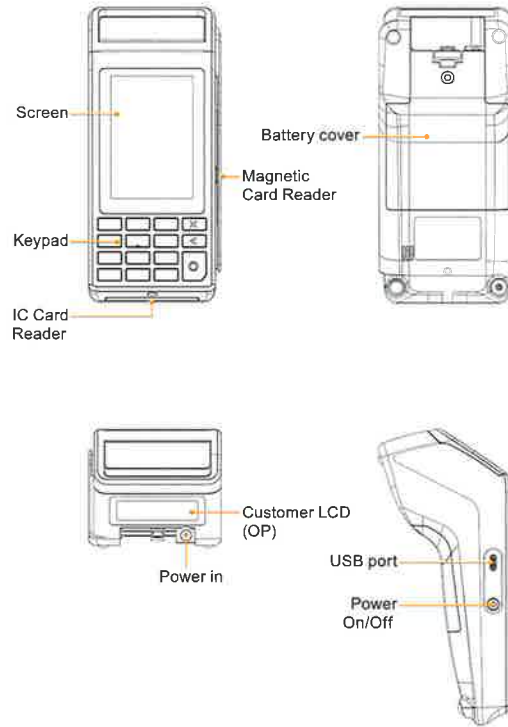

T6 Countertop POS terminal

Operation Manual

Structure Description



Instructions

Power on /off

Power on: Press "⏻" for 2-3 seconds, screen backlight appear, and terminal power on.

Power off: Press "⏻" for several seconds, screen display "power off, please confirm or cancel", press confirm, power off.

Magnetic card

Please put the card magnetic strip towards to track device inside when swipe the card, it can support both directions; Make sure to swipe the card stably and constantly.

Note: The transaction may be fail if magnetic card's tripe is damaged or swipe solution is wrong.



IC card

IC card slot locate in the bottom of the keypad, keep the chip side up when swiping card, and insert IC card to the end. The IC card should be inserted in the IC card slot during the transaction process.

Note: The transaction probably fail if IC card chip contact point is damaged or is oxidative.



Contactless card

Please put card close to the NFC area, and stay for one second, then remove card when you hear a "Di" voice, showing as follow picture.



Tear-off Print Paper

Hold print paper, tear-off the print paper according to picture direction, keep direction from left to right, the strength should keep fast and equality during cutting paper.

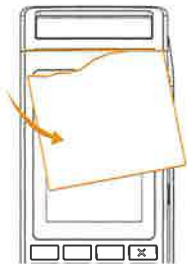

Install Battery

⚠ Make sure the adapter is disconnected before installing the battery

1. Disconnect the adapter
2. Open battery cover.
3. Keep battery connector connect with the white slot
4. Put battery into the battery compartment
5. Close battery cover



Remove Battery

1. Power off
2. Disconnect the adapter
3. Open battery cover
4. Take battery to the appropriate height
5. Take out battery connector, and remove battery

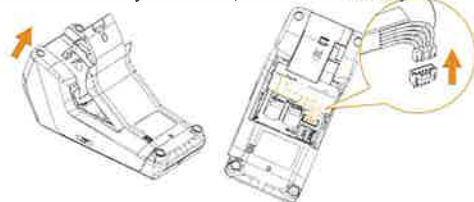

Install SIM

1. Open battery cover
2. Insert SIM card as the picture show below.
(Note: chip side of card face terminal)

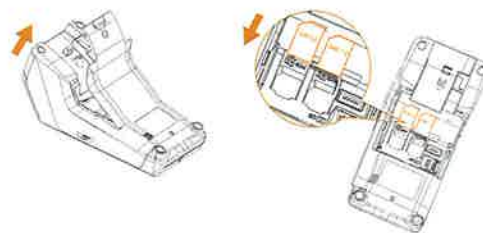

Remove SIM

1. Open battery cover
2. Press SIM and remove out

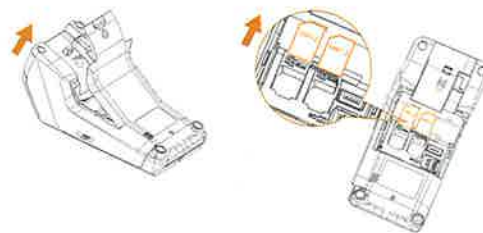

Print Process



1. Open paper roll cover.
2. Hold the print paper by hand, tear it down towards the direction as shown in the pic.
3. Close the print roll cover and hear "kada" voice.

Common Fault Process

If the above solution can't solve the problem or have other questions, please contact maintainer.



Company address: 17B JinSong Mansion, Terra Industrial & Trade Park, Chegongmiao, Futian District, Shenzhen
Manufacturer: Shenzhen Xinguodu Technology Co.,Ltd.
Factory address: C Building Dagang Industry Area, Changzhen District, Gongming, Guangming, Shenzhen
Telephone: +86-755-26067135
Website: www.nexgoglobal.com

Category	Fault	Reason	Solution
Power on/off	No display when power on	1.Out of battery. 2.Install battery error.	1.Connect AC power. 2.Confirm battery whether install OK
Button	No response when press the key button.	Terminal crashed	Reboot the terminal
Communication	Prompt "Communication timeout"	1.Wireless Signal is weak or no signal. 2.SIM card contact is poor. 3.Terminal software issue.	1.Move the POS terminal to window or wide open space. 2.Reinsert the SIM card. 3.Reboot the terminal
	Prompt "Please insert the SIM card"	1.SIM card is damaged. 2.SIM card plug wrong position	1.Check the SIM card is good condition or not, surface of the chip is oxidized or not, clear the SIM card chip with soft cloth. 2.Reinsert the SIM card.
Print	No display when print.	Thermal printer paper is set upside down.	Reset the print paper as the instruction
	Print color is too light.	Printer paper is not qualified.	Change qualified printer paper

Category	Fault	Reason	Solution
Read card failure	Prompt "Card read error, please reswipe the card"	1.There is dirt on magnetic head. 2.Magnetic card is dirty or demagnetization 3.Swipe the card in a wrong way.	1.A piece of moderate hard cardboard put card slot, and drag several times by light horizontal and vertical direction, and then wipe away the dirt from the head. 2.Remove the dirt on the magnetic card by soft paper, if the card has problem itself, try to change the card in the issue bank. 3.Pay attention to the surface of the magnetic direction, and the speed of swiping card should keep equality.
			Terminal can not charging
		Li-battery long time storage of the lead to battery no power, lower the charging threshold voltage, it can back normal after activate.	Keep charging more than 15 minutes after seeing red battery logo on the screen, then the logo will become green, and progress bar goes normal that it indicate battery already been activated, you can use battery after fully charging.

Attention Of Installation And Operation

- Please follow the instruction strictly when install and connect the terminal.
- Do not damage the power line and power adaptor. It can't be used any more if the power line or power adaptor is damaged.
- Please check power supply socket whether complying with terminal set voltage before insert the AC socket. Recommend to choose the fuse socket, and grounding well.
- Please leave the terminal away from liquid, and forbidden splash into any liquid or electric conduction material, otherwise it will cause a short-circuit or damage to the terminal.
- Please do not insert any foreign material into any ports, it will damage the terminal seriously.
- Please contact the professional POS maintainer When the terminal have fault, users or other non-qualified POS maintainer should not repair the terminal.
- Please do not touch the cutter knife in case of hurt when install the paper roll.
- Please use the standard print paper in case of paper jam or printer damage.
- Please do not shake or knock the terminal.
- Please do not use or place flammability spray, painting, etc. in case of fire.
- Forbid to disassemble or remake the terminal: Forbidden to use the terminal in illegal way, offenders will stand legal responsibility.

Components	Hazardous and noxious substances or elements					
	Pb	Hg	Cd	Cr(VI)	PBB	PBDE
PCB Components	O	O	O	O	O	O

Notes:

- 1) O means the content of this hazardous and noxious substance in all the homogeneous material of the component is below the requirement of SJ/T 11363-2006 standard
- 2) X means the content of this hazardous and noxious substance at least in certain homogeneous material is higher than the requirements of SJ/T 11363-2006 standard; but the components marked by "X" in the above form are all due to the current industry technology develop level and cannot realize the substitution of the hazardous and noxious substances or elements

Environmental protection indication:

for the products which arrives or exceeds the use life, should be recycled used according to <The Management of Electronic and Information Product >, cannot discard arbitrarily.

Packing list

No.	Item	Quantity
1	Mobile POS	1
2	Operation Manual	1
3	Battery	1
4	Adapter	1

Announcement

Shenzhen Xinguodu Technology Co.,Ltd reserves the right to modify this manual without prior notice and continuously improve the accuracy, adequacy and completeness of the information contained in this manual.

Shenzhen Xinguodu Technology Co.,Ltd does not accept any legal responsibility for the adverse consequences caused by-using this product not in accordance with this manual or using accessories which are not supplied by Shenzhen Xinguodu Technology Co.,Ltd.

This manual is copyrighted by @ Shenzhen Xinguodu Technology Co.,Ltd.